

HoldenCopley

PREPARE TO BE MOVED

Black Swan Close, Nottingham, Nottinghamshire NG5 3JG

£550 PCM

Black Swan Close, Nottingham, Nottinghamshire NG5 3JG



LOCATION LOCATION LOCATION

This well presented second floor apartment sits within a popular development in the sought after location of Woodthorpe. Offering two bedrooms, a large living room as well as separate kitchen and bathroom the apartment would make a great home for working professionals. Situated within walking distance to Sherwood's vibrant shops and cafes it also benefits from excellent transport links to and from the city and easy access to the City Hospital and ring road.

AVAILABLE NOW





- Two Bedrooms
- Second Floor
- Unfurnished
- Popular Development
- Parking
- Well Presented
- Sought After Location
- Available Now





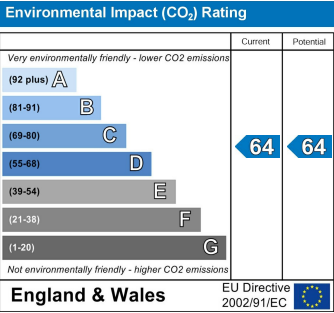
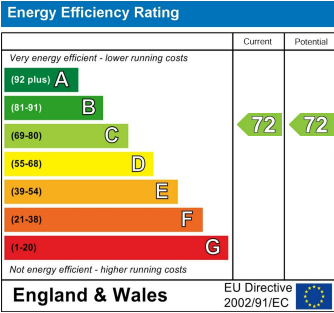

Black Swan Close, Nottingham, Nottinghamshire NG5 3JG

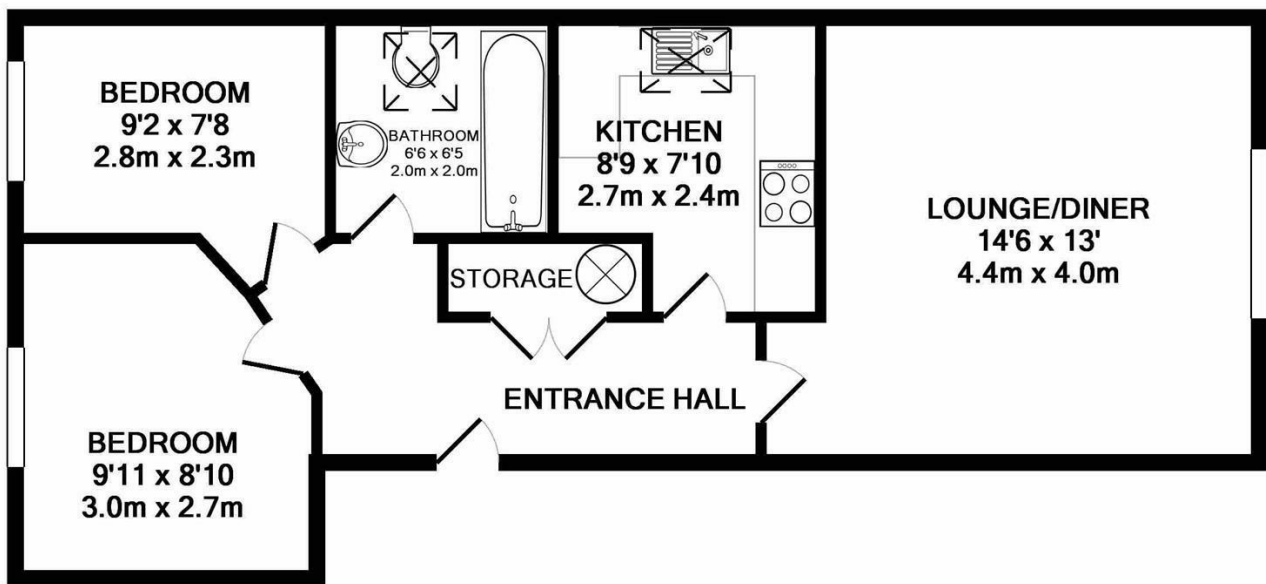

TOTAL APPROX. FLOOR AREA 500 SQ.FT. (46.4 SQ.M.)

Whilst every attempt has been made to ensure the accuracy of the floor plan contained here, measurements of doors, windows, rooms and any other items are approximate and no responsibility is taken for any error, omission, or mis-statement. This plan is for illustrative purposes only and should be used as such by any prospective purchaser. The services, systems and appliances shown have not been tested and no guarantee as to their operability or efficiency can be given

Made with Metropix ©2018

0115 8969 800

26 High Street, Arnold, Nottinghamshire, NG5 7DZ

sales@holdencopley.co.uk

www.holdencopley.co.uk